

Acid Tactical®

## 15" Paracord Jig Directions

### 15" Paracord Jig Directions

Included parts:

1 - 15" Track 1 - Suction Cup 1 - Wing Nut 1 - Wood Screw (Optional for permanent mounting)	2 - Clasp Towers 2 - Horizontal Rod w/plastic nut 2 - Wing Bolt & Nut
--	---



### Attaching suction cup

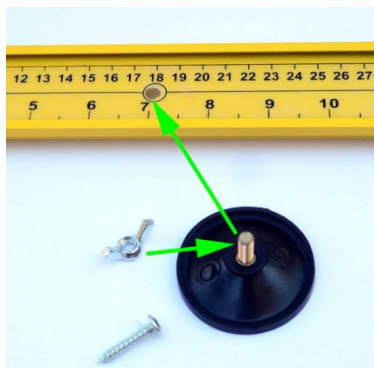

Dampen the bottom of the suction cup and press onto a clean flat surface.

Place the jig onto the suction cup bolt. Secure using wingnut.

Do not overtighten or you will lose suction to your surface.

Use the optional screw for permanent mounting to a work bench.

## Attaching Towers to track.



#1. Insert nut underneath tower.



#2. Hold the nut in place while sliding the tower into the track.

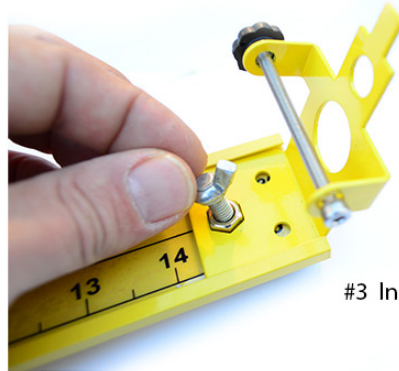

#3 Insert wing bolt into nut.

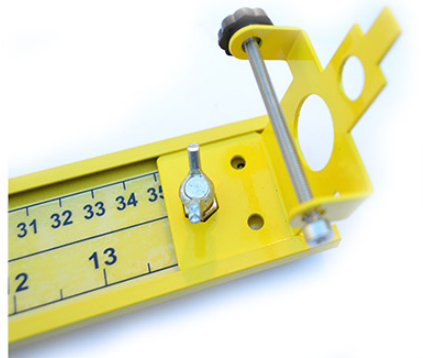

4. Slide the tower to obtain the desired length for your project. Tighten the wing bolt to lock the tower. Do not over tighten.

5. Repeat for opposite tower.

Assembled Jig ready to use.



### Clasps / Buckles

\*Due to the variety of sizes, Clasps are NOT included. Purchase clasps with your paracord.

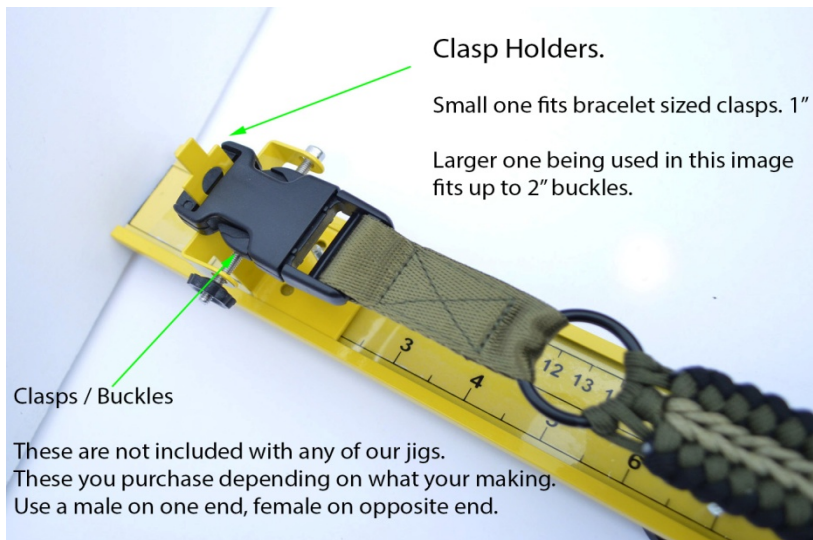
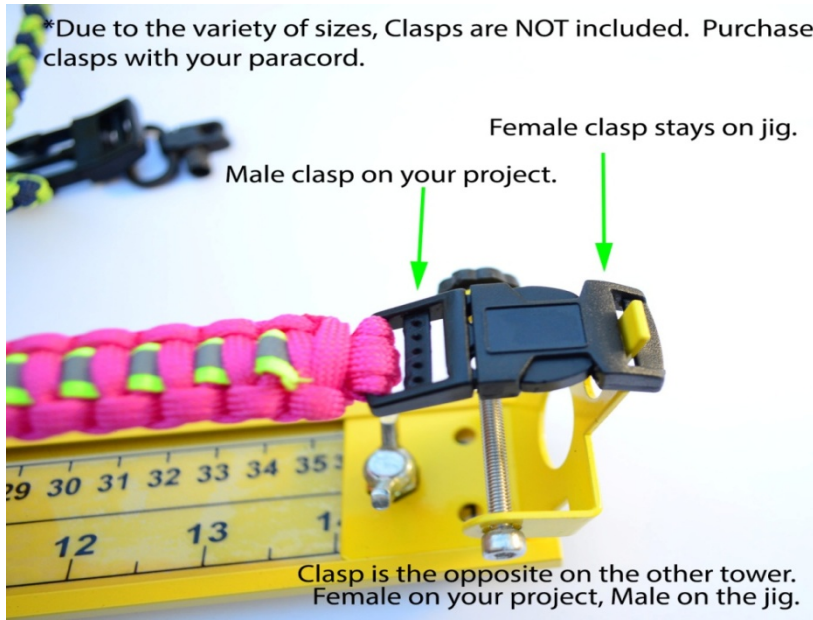

Acid Tactical LLC  
Inman, SC 29349