

Included parts:

- 2 - 15" Track (A)
- 2 - Clasp Towers (B)
- 2 - Suction Cups (C)
- 2 - Horizontal Rod w/plastic nut (D)
- 3 - Wing Nuts (E.)
- 2 - Nuts (F)
- 1 - Bolt (G)
- 2 - Wing Bolt (H)
- 2 - Wood Screws (I) (Optional for permanent mounting)

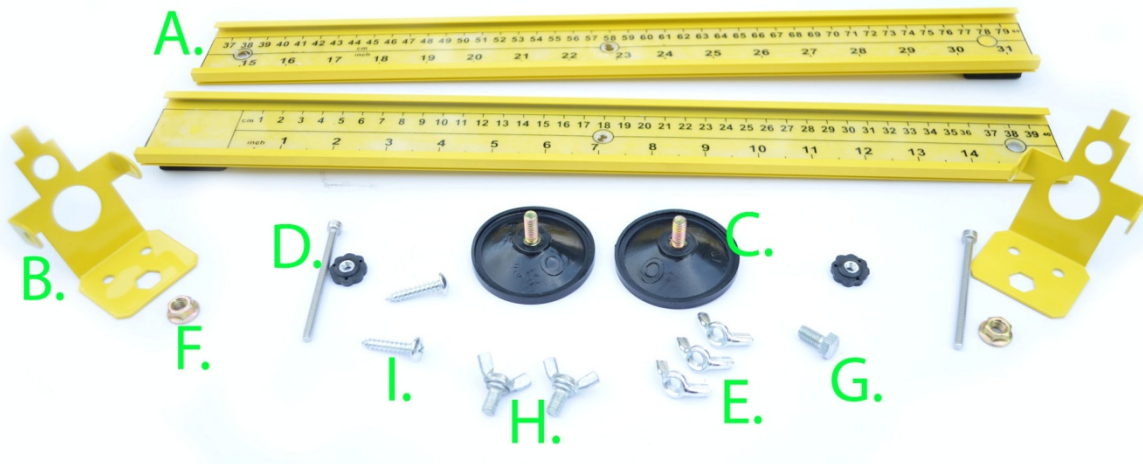

Assembling Track



Connect the track by inserting the 15" - 31" section into the bottom guides of the 1"-15" section. Align the holes that are cut into the two sections at the 15" marks.



Insert a bolt(G) from the underside of the tracks through the hole. Secure using a wing nut (E).

Moisten the underside of suction cups(C) and place a suction cup under the 7" hole and another under the 23" hole.

Screw a wing nut(E) a couple of turns onto each of the suction cups threaded bolt. Do not tighten.

Place the jig on a flat surface where you would like to work. Press firmly on each wing nut to secure the jig to the surface.

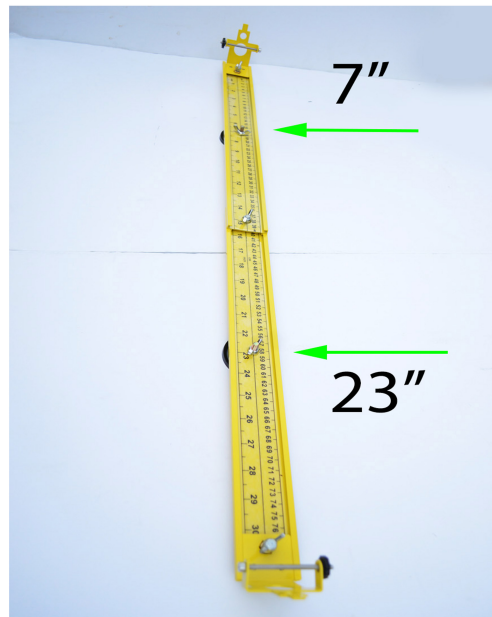
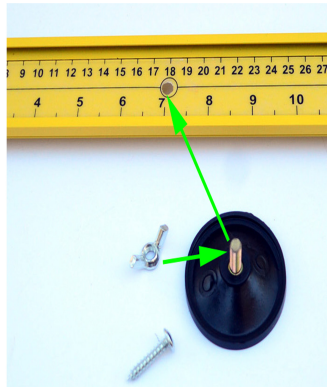

Tighten the wing nuts but do not overtighten.

Use the optional screw for permanent mounting to a work bench.

Attaching Towers to track.



#1. Insert nut (F) underneath tower.



#2. Hold the nut in place while sliding the tower into the track.



#3 Insert wing bolt(H) into nut.



4. Slide the tower to obtain the desired length for your project. Tighten the wing bolt to lock the tower. Do not over tighten.

5. Repeat for opposite tower.

Assembled Jig ready to use.



Clasps / Buckles

*Due to the variety of sizes, Clasps are NOT included. Purchase clasps with your paracord.

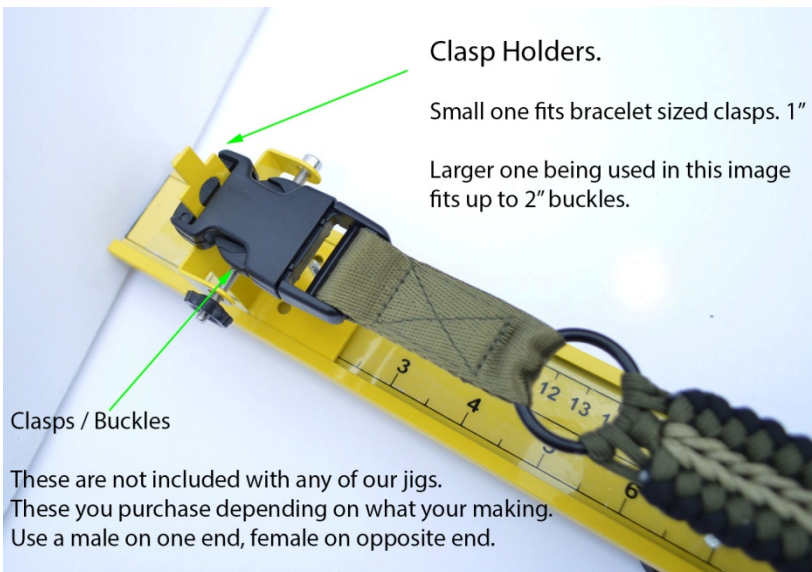
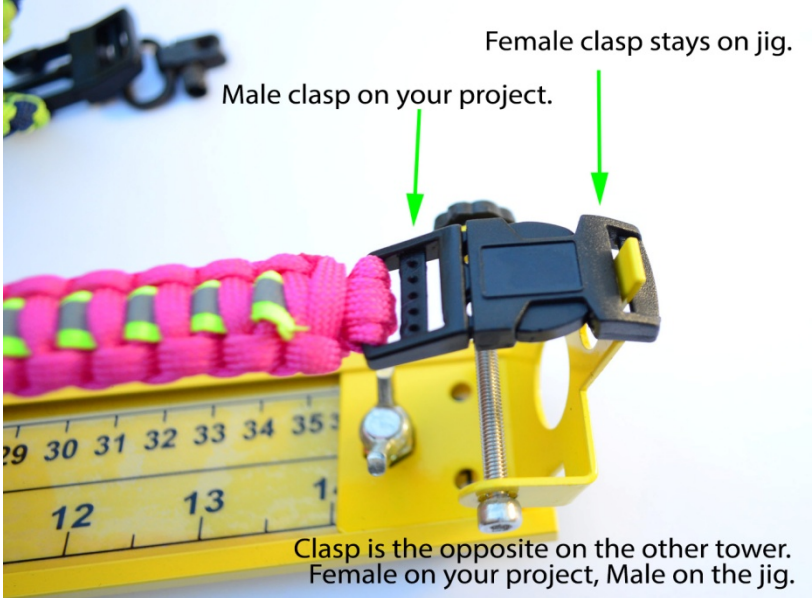

Acid Tactical LLC
Inman, SC 29349